

RPNZ document ordering service

Certificate of Title with diagram: CB16K/142

Property: 6/33 Torrens Road, Hillmorton, Christchurch City

**Legal Description: Unit F and Accessory Unit F1, F2 and F3 Deposited Plan
38532**

CoreLogic Reference: 3178794/1

Processed: 21 February 2024

Sourced from RPNZ, a CoreLogic solution. For any queries about this document or this service please call 0800 82 55 78 or email documentordering@corelogic.co.nz.



**RECORD OF TITLE
UNDER LAND TRANSFER ACT 2017
UNIT TITLE
Search Copy**



R.W. Muir
Registrar-General
of Land

Identifier **CB16K/142**
Land Registration District **Canterbury**
Date Issued 25 August 1976

Prior References
CB197/238

Supplementary Record Sheet
CB14K/182

Estate Stratum in Freehold
Legal Description Unit F and Accessory Unit F1, F2 and F3
 Deposited Plan 38532

Registered Owners
Roseann Raewyn Taylor

The above estates are subject to the reservations, restrictions, encumbrances, liens and interests noted below and on the relevant unit plan and supplementary record sheet

12214939.3 Mortgage to Southland Building Society - 14.9.2021 at 2:19 pm

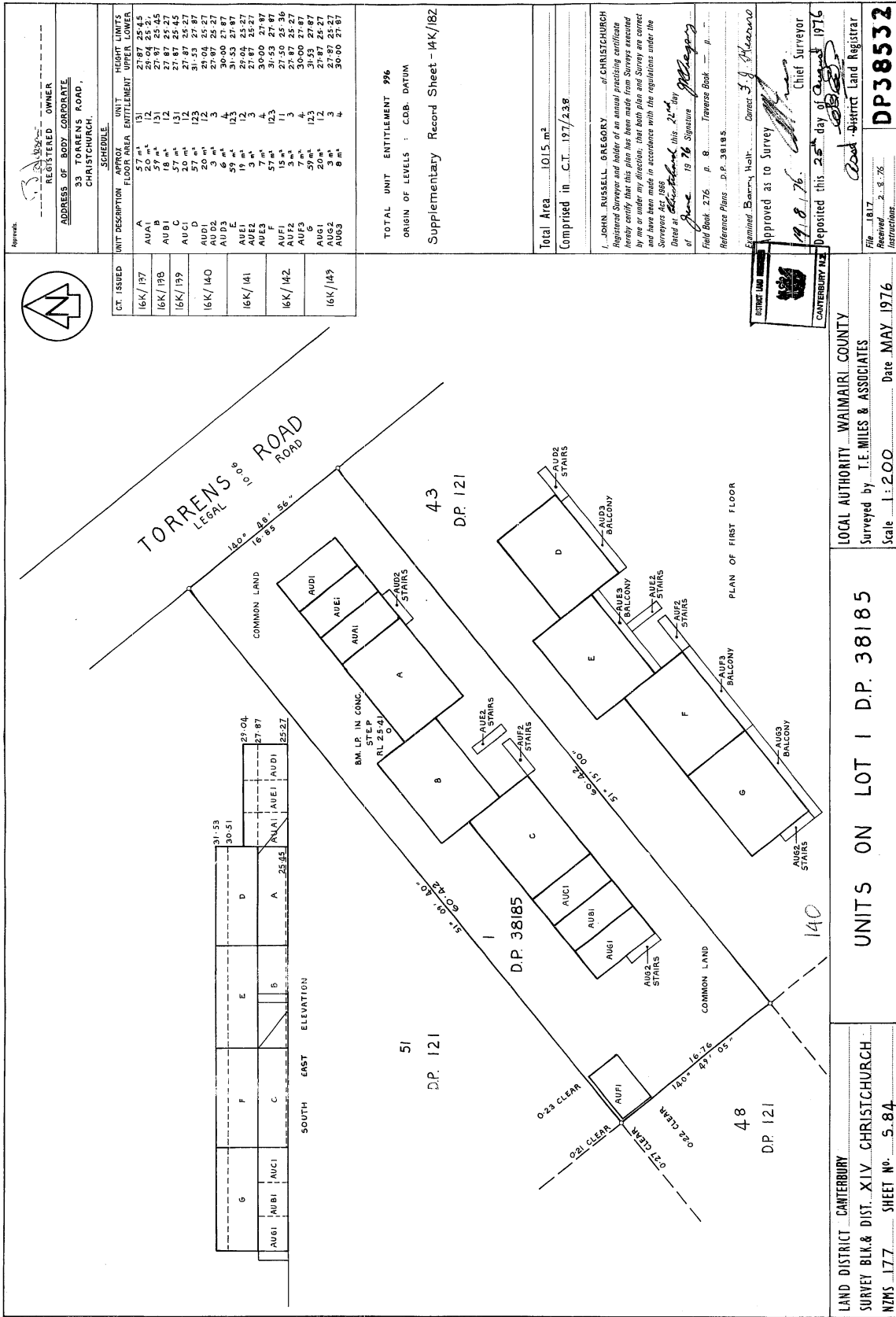

APPROVED: *[Signature]*
 REGISTERED OWNER
 ADDRESS OF BODY CORPORATE
 33 TORRENS ROAD,
 CHRISTCHURCH.

SCHEDULE

UNIT DESCRIPTION	APPROXIMATE FLOOR AREA	ENTITLEMENT	LOWER LEVELS	UPPER LEVELS
A	57 m ²	131	27.87	25.45
AUA1	2.0 m ²	12	29.04	25.21
B	57 m ²	131	27.87	25.45
AUB1	2.0 m ²	12	29.04	25.21
C	57 m ²	131	27.87	25.45
AUC1	2.0 m ²	12	27.87	25.27
D	57 m ²	123	31.53	27.87
AUD1	2.0 m ²	13	27.87	25.27
E	59 m ²	4	30.00	27.87
AUE1	1.9 m ²	123	31.53	27.87
F	57 m ²	123	31.53	27.87
AUF1	1.5 m ²	11	27.50	25.36
G	59 m ²	7	30.00	27.87
AUG1	2.0 m ²	123	31.53	27.87
AUG2	3 m ²	3	27.87	25.27
AUG3	8 m ²	3	30.00	25.67

TOTAL UNIT ENTITLEMENT 996
 ORIGIN OF LEVELS : CDB, DATUM
 Supplementary Record Sheet - 14K/182

Total Area 1015 m²
 Comprised in C.T. 177/238

I, JOHN RUSSELL GREGORY, of CHRISTCHURCH, Registering Surveyor and holder of an annual practicing certificate, do hereby certify that the above plan and Stairs are correct and have been made in accordance with the regulations under the Surveyors Act 1969.
 Dated at Christchurch this 25th day of June 1976
 Signature *[Signature]*
 Field Book 276 p. 8 Traverse Book
 Reference Plans D.P. 38185
 Examined Barry Healt, Const. J. Mearns
 Approved as to Survey *[Signature]* Chief Surveyor
 19/8/76
 Deposited this 25th day of August 1976
 Road District Land Registrar

File 1817
 Received 2.5.76
 Instructions
DP38532
 US 10M x 83

LOCAL AUTHORITY WAIMAIRI COUNTY
 Surveyed by I.E. MILES & ASSOCIATES
 Scale 1:200 Date MAY 1976

UNITS ON LOT 1 D.P. 38185

LAND DISTRICT CANTERBURY
 SURVEY BLK. & DIST. XIV CHRISTCHURCH
 NZMS 177 SHEET NO. 5.84

Printed by Unipress Printworks Ltd., Wellington, New Zealand.



**SUPPLEMENTARY RECORD SHEET
UNDER UNIT TITLES ACT 1972**

Search Copy

Identifier

CB14K/182

Land Registration District **Canterbury**

Date Issued 25 August 1976

Plan Number DP 38532

Subdivision of

Lot 1 Deposited Plan 38185

Unit Titles Issued

CB16K/137

CB16K/138

CB16K/139

CB16K/140

CB16K/141

CB16K/142

CB16K/143

Interests

OWNERSHIP OF COMMON PROPERTY

Pursuant to Section 47 Unit Titles Act 2010 -

(a) the body corporate owns the common property and

(b) the owners of all the units are beneficially entitled to the common property as tenants in common in shares proportional to the ownership interest (or proposed ownership interest) in respect of their respective units.

The above memorial has been added to Supplementary Record Sheets issued under the Unit Titles Act 1972 to give effect to Section 47 of the Unit Titles Act 2010.